

## Configurable AIMS

Configurable Advanced Ion Mobility Spectrometer (AIMS) is an excellent tool for **monitoring fast processes** with high sensitivity requirement. In addition to detection of volatile and semi-volatile compounds, our IMS is the only one in the field which is suitable for solids analysis and surface analysis. The AIMS from MaSaTECH can easily achieve the resolution of up to 90 FWHM (full width half maximum), which makes it an instrument with highest resolving power in the field.

The high performance Corona Discharge ion source outperforms the conventional ions sources used in IMS and the high ion current is responsible for the ultra-high sensitivity of the advanced ion mobility spectrometer. It is a perfect solution for those who need **specific layout of all AIMS components**. The main components of Configurable AIMS are Engine and Control Unit. Individual parts may be spaced at a distance of 0.5-2m.

### AIMS Control Unit

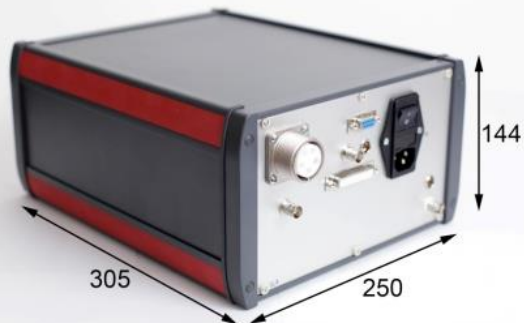

### AIMS Engine

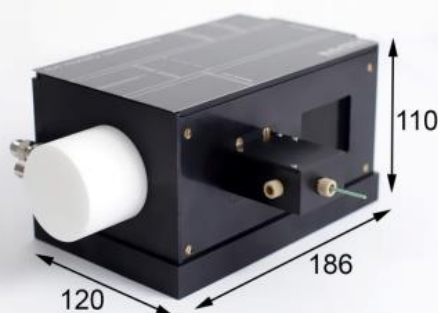

The **AIMS** is designed for:

- Fast and remote monitoring of processes
- Product quality control in industry
- Volatile organic compounds monitoring
- Trace gases detection, gas detector
- Analysis of solids and surfaces
- Explosives detection
- Drug quality control
- Interface to Gas Chromatograph or to Multi Capillary Column Gas Chromatograph
- Research laboratories
- Environmental monitoring
- Indoor/Outdoor air quality monitoring
- Chemical analysis

Working pressure	600-1200 mbar
Working temperature	30-120 °C
Max. resolving power N <sub>2</sub> /Air	100/90 FWHM
Sensitivity	ppb
Drift gas flow	500-1200 ml/min
Sample gas flow	5-500 ml/min
Drift field intensity	200-560 V/cm
Polarity	Positive or Negative
Ionization source	Corona Discharge
Power supply	250V / 24V

# AIMS Control Unit

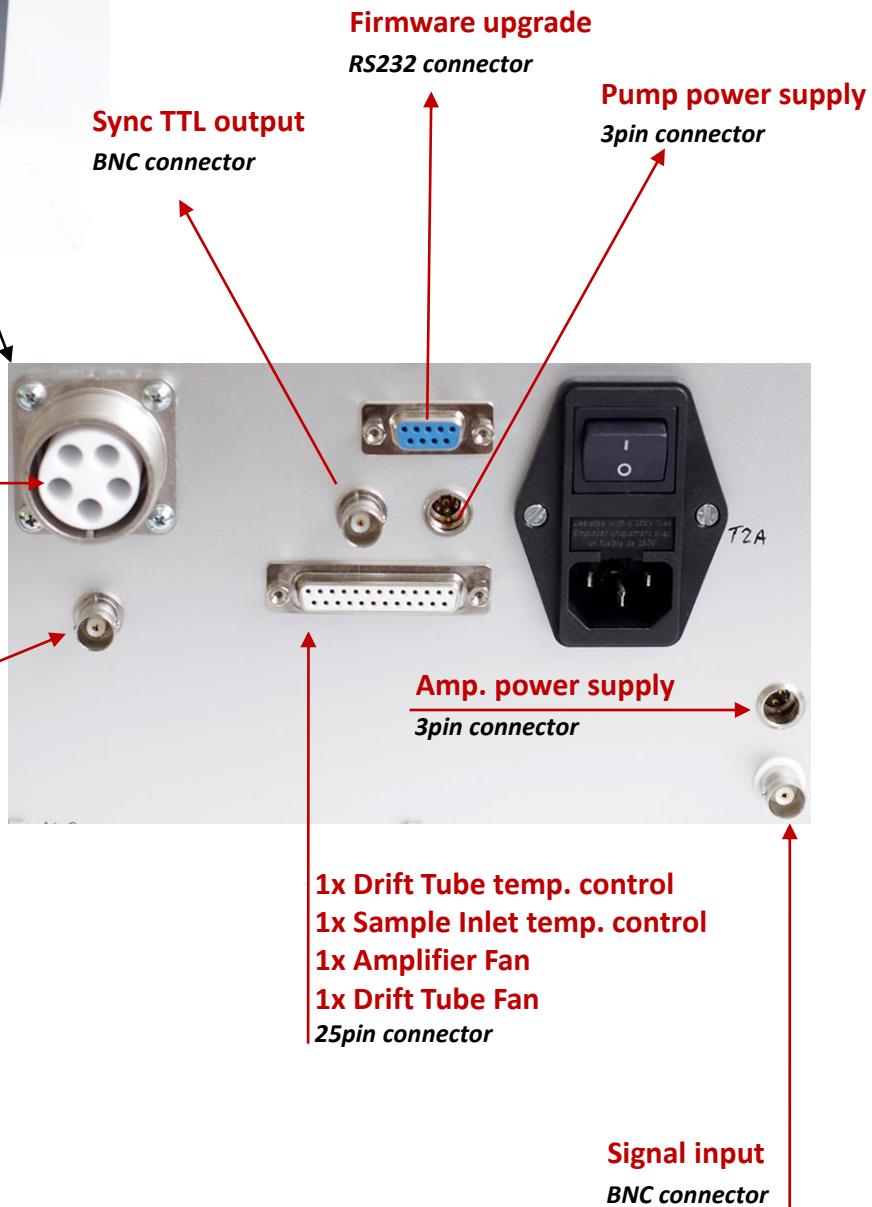
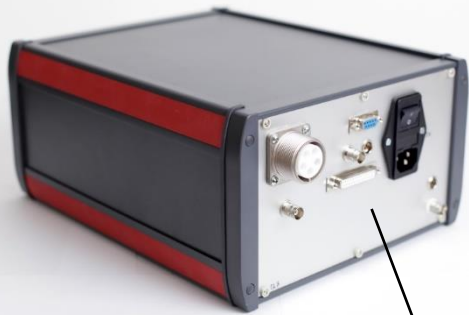
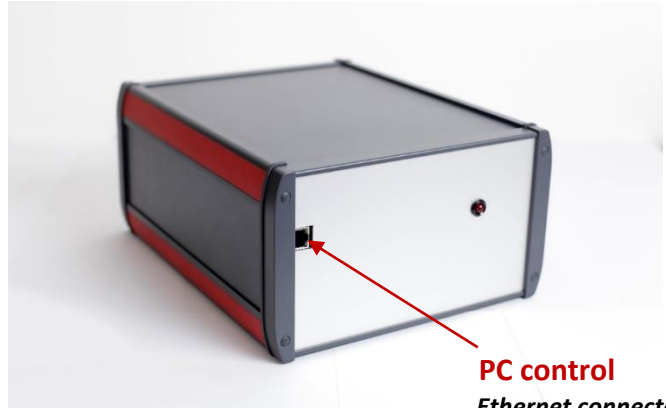

# AIMS Engine



**Sample inlet**  
1/16" connector

**Signal output**  
BNC connector

**Amplifier power supply**  
3pin connector

**1xHV - Target electrode input**  
**1xHV - SG output**  
**2xHV - SG control input**  
HV 5pin connector



**Drift gas inlet**  
3mm connector

**Pressure control**  
3mm connector

**Alternative gas exhaust**

**HV - Corona Discharge Input**  
SHV connector

**Gas exhaust**  
6mm connector